

New TiAL wastegates

MV-R wastegates

Available in red, purple, black, silver and blue, the MV-R is the replacement for the popular V44. Center lines and flanges are identical to the V44, making this a 100% replacement piece. MV-R is about an inch shorter than the V44 allowing for compact installs. It features water cooling ports (not required to run) for those heavy duty applications, three bottom pressure ports and two top ports for boost controllers like the AMS-1000.

This is a total replacement for the V44, production of the V44 has been discontinued.

For more details see: http://www.turbomaster.info/eng/applications/wastegate_MVR_eng.php



MV-S wastegates

Available now in red, purple, black, silver and blue, this revamp features water cooling ports (patent pending) three bottom air ports and two top air ports. Water ports are not required for operation, but come in handy if you are road racing, the top hat is close to the turbine housing/down pipe or you have an engine bay that doesn't get a lot of airflow. Air and Water ports are clearly marked so there is no confusion.

Water Cooled, Re-designed Top.

For more details see: http://www.turbomaster.info/eng/applications/wastegate_MVS_eng.php



MV-S
watercooled
— & —
MV-R
watercooled



removable
-4 AN fitting



new water cooling ports now come standard on all MV-S and MV-R TIAL wastegates

water cooling is **not required** for typical street car applications

water cooling is required if:

- you road race the car
- you have low/no airflow in your engine bay
- you downpipe/exhaust manifold comes close to the top hat of the wastegate

rotary applications are not required to run water but highly recommended

water enters one port, flows around the base and out the opposite port

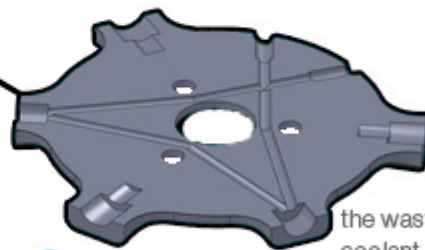

the wastegate uses little coolant which will have no effect on the rest of the cooling system

